



## Royal Connaught Park

Bushey

£749,999

A three bedroom, chain-free, semi detached house available with Davidson Frost-Wellings in the popular Royal Connaught Park.

Downstairs the house is well laid out with a large family room with kitchen, dining and living space with sliding doors leading to a private rear garden. There is also an additional reception room, guest WC, utility room and ample storage.

Upstairs the property has a master bedroom with attractive views over the Royal Connaught grounds and an en suite bathroom, with two further double bedrooms, both with built-in storage and a family bathroom. The house has electric blinds and curtains, lots of built-in storage and two allocated parking spaces just outside the front door.

The house is a modern and semi-detached within this private gated development, formerly The Royal Masonic School. The house comes with access to the on-site leisure centre with gym and swimming pool, tennis courts, events space, a shuttle bus to station and shopping centre, 100 acres of grounds and 24 hour security.

Leasehold of 125 Years from 1st January 2016.  
Service charges of approximately £5,580 per year.  
Ground rent of approximately £720 per year.  
Hertsmere Council Tax Band G.

- Three Bedrooms
- Two Bathrooms
- Private Garden
- Two Parking Spaces
- Chain Free
- Semi-Detached Leasehold

### Viewing

Please contact our Davidson Frost-Wellings Office on 020 8954 8806 if you wish to arrange a viewing appointment for this property or require further information.



# Floor Plan

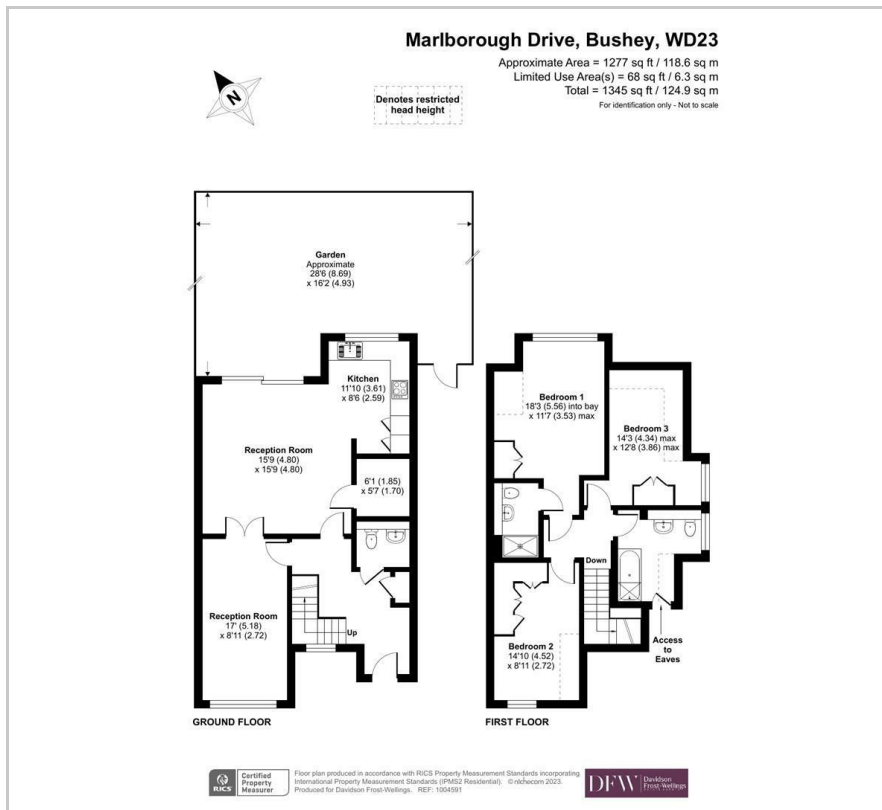

# Area Map

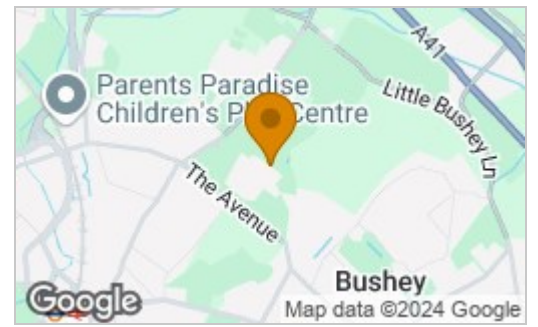

## Energy Efficiency Rating

	Current	Potential
Very energy efficient - lower running costs		
(92 plus) <b>A</b>		<b>93</b>
(81-91) <b>B</b>	<b>84</b>	
(69-80) <b>C</b>		
(55-68) <b>D</b>		
(39-54) <b>E</b>		
(21-38) <b>F</b>		
(1-20) <b>G</b>		
Not energy efficient - higher running costs		
<b>England &amp; Wales</b>	EU Directive 2002/91/EC	



These particulars, whilst believed to be accurate are set out as a general outline only for guidance and do not constitute any part of an offer or contract. Intending purchasers should not rely on them as statements of representation of fact, but must satisfy themselves by inspection or otherwise as to their accuracy. No person in this firm's employment has the authority to make or give any representation or warranty in respect of the property.